

TECHNICAL DATA SHEET

ASQUITHS
BATHROOMS OF TRANSFORMATION

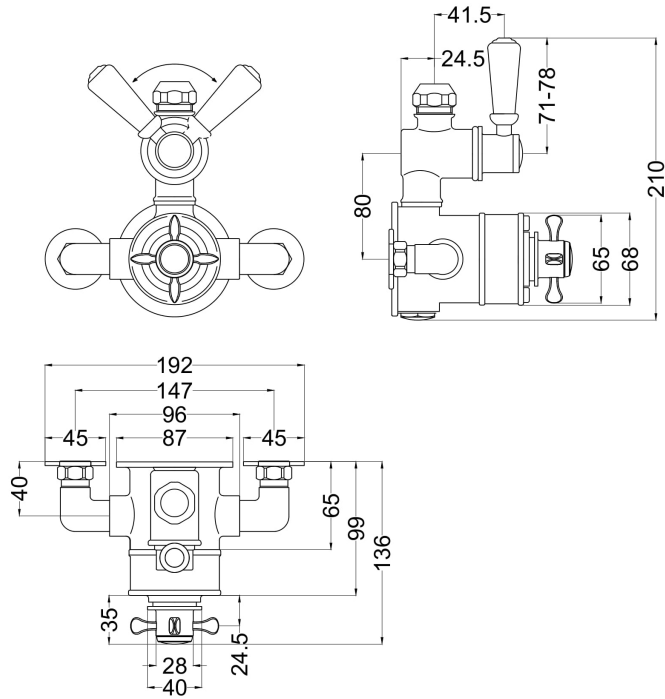

Product Line Drawing

Product Image

SHOWERS

SHE5318

Restore Twin Exposed Shower Valve

PRODUCT DETAILS

Height:	206				
Width:	195				
Depth:	135				
Length:					
Nett Weight:	3.2				
Country of Origin:	United Kingdom				
Fitting Instruction:	Yes				
Product Material:	Brass				
TMV2 Approval:	No	Number: N/A			
TMV3 Approval:	No	Number: N/A			
WRAS Approval:	No	Number: N/A			
Operating Pressure (Bar):	0.1				
Flow Rate (Bar / Ltr per min):	0.1/ 4.5	0.5/13	1/18.5	2/26	3/ 33
Valve / Cartridge Type:	1/4 Turn Ceramic Disc				
Colour / Finish:	Chrome				
Mount Type:	Wall				
Outlet Elbow Supplied:	Not Applicable				
Pipe Size:	15 mm (1/2" Bsp)		Centres: 150mm		
Easy Clean:	Not Applicable				
Head Included:	No	Function: Not Applicable			
Handset Included:	No	Function: Not Applicable			
Body Jets Included:	No	Quantity: Not Applicable			
Hose Included:	Not Applicable				

PACKAGING DETAILS

Height:	170		
Width:	215		
Length:	245		
Gross Weight:	3.2		
Box Colour:	White Cardboard Box Quantity: 1		
Label Colour:	White Label	Quantity: 1	
Label Size:	100 x 50		
Barcode:	5056211809647		