

Product Image

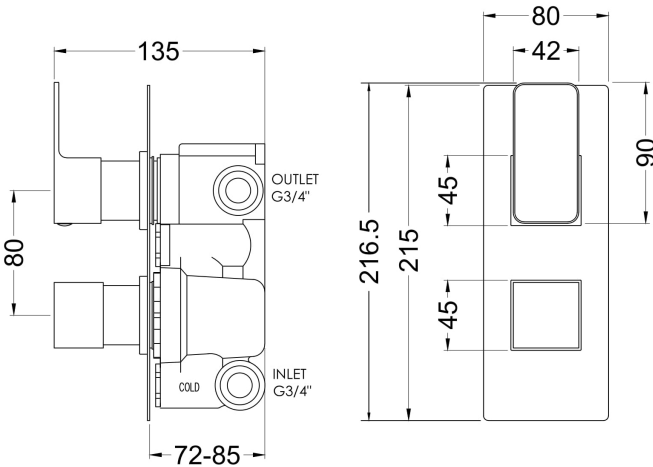

Product Line Drawing

SHOWERS

SHD5115

Tranquil Twin Therm Valve W/Div

PRODUCT DETAILS

Height:	215				
Width:	120				
Depth:	135				
Length:					
Nett Weight:	2.9				
Country of Origin:	United Kingdom				
Fitting Instruction:	Yes				
Product Material:	Brass/ABS				
TMV2 Approval:	No	Number: N/A			
TMV3 Approval:	No	Number: N/A			
WRAS Approval:	No	Number: N/A			
Operating Pressure (Bar):	0.5				
Flow Rate (Bar / Ltr per min):	0.1 / N/A	0.5 / 13	1 / 17	2 / 24	3 / 27
Valve / Cartridge Type:	1/4 Turn Ceramic Disc				
Colour / Finish:	Chrome				
Mount Type:	Recessed, Wall				
Outlet Elbow Supplied:	No				
Pipe Size:	22 mm (3/4" Bsp)		Centres: N/A		
Easy Clean:	Not Applicable				
Head Included:	No	Function: Not Applicable			
Handset Included:	No	Function: Not Applicable			
Body Jets Included:	No	Quantity: Not Applicable			
Hose Included:	Not Applicable				

PACKAGING DETAILS

Height:	110		
Width:	240		
Length:	250		
Gross Weight:	2.9		
Box Colour:	White Cardboard Box Quantity: 1		
Label Colour:	White Label Quantity: 1		
Label Size:	100 x 50		
Barcode:	5056211809029		